



Wallmount Type 4 -channel MPEG-4 Video Server with Two Way Audio

ACD-2200



- MPEG-4 SP compression
- CIF up to Full D1 resolution at 30/25 FPS per channel
- Digital time code embedded for each channel
- Motion detection for each channel
- Two-way audio supported for each channel
- Isolated digital input and output supported for each channel
- Isolated serial ports for each channel

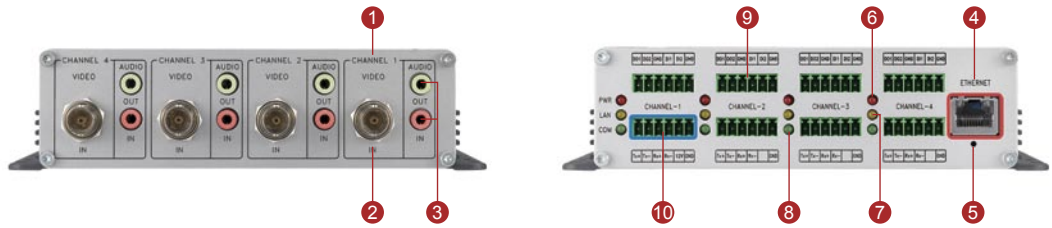

- | | | | |
|------------------|------------------------|-----------------|------------------------------------|
| ① Channel number | ③ Audio input / output | ④ Ethernet port | ⑧ RS-485 LED |
| ② Video input | | ⑤ Reset button | ⑨ Digital input & digital output |
| | | ⑥ Power LED | ⑩ Serial port & DC 12V power input |
| | | ⑦ LAN LED | |

DIMENSION DIAGRAM

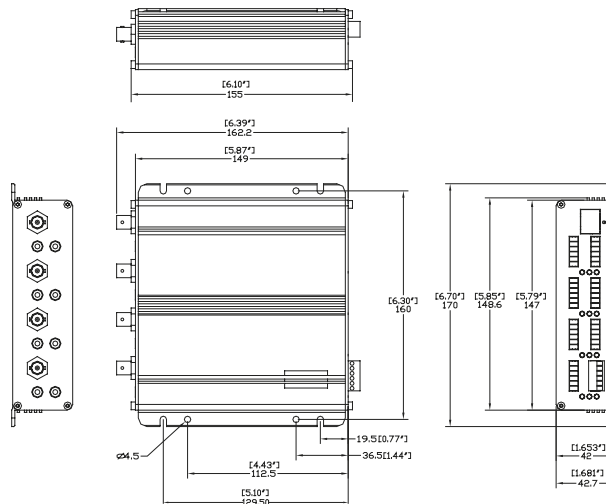

Unit: mm [inch]

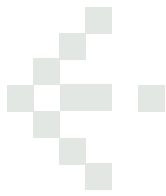
**PRODUCT SPECIFICATION**

Video Compression		External I/O	
Compression	MPEG-4 SP Compliant	Reset Button	Factory default
Picture Resolution	Full D1 (720x480 in NTSC, 720x576 in PAL) CIF (352x240 in NTSC, 352x288 in PAL) QCIF (160x112 in NTSC, 176x144 in PAL) (per channel)	LED	System status (per channel)
Bit Rate	28K ~ 3M bps (per channel)	Network	
Image Frame Rate	30fps at full D1 resolution (NTSC) 25fps at full D1 resolution (PAL) (per channel)	Ethernet Port	Ethernet (10/100 Base-T), RJ-45 Connector
Video Input		Protocol	TCP, UDP, IP, HTTP, DHCP, PPPoE, RTP, RTSP
Composite Input	4, CVBS, 1.0Vp-p with 75Ω loading, BNC Connector	Software	
Audio Input		Web Browser	Microsoft Internet Explorer 6.0 or above
Compression	8 kHz, Mono, PCM	SDK	ActiveX control, C SDK
Audio Line Input	4, Unbalanced, 1.4 Vpp, 1Vrms, 3.5 mm Phone Jack	Security	Password protection: configured by the administrator
Audio Output		Operating	
Compression	8 kHz, Mono, PCM	Temperature	0 ~ 40 °C (0 ~ 104°F)
Audio Line Output	4, Unbalanced, 1.4 Vpp, 1Vrms, 3.5 mm Phone Jack	Power	
Alarm		Power Requirement	DC 12 V ±10%
Input	2, TTL, terminal block (per channel)	Power Consumption	1.31 A 15.72 W
Output	2, TTL, terminal block (per channel)	Physical	
Remote Control		Dimensions (WxHxD)	170 mm x 42.7 mm x149 mm (6.70"x1.68"x5.87")
Serial Port	RS-485: half duplex, terminal block RS-422: full duplex, terminal block RS-232: full duplex, terminal block (per channel)	Weight	820 g (1.80 lb)

ORDERING INFORMATION

Model Name	Description
ACD-2200	Wallmount Type 4 -channel MPEG-4 Video Server with Two Way Audio